

File name: \\EU\AECOM\NET\COM\MEMIA\KIE\B\2\JOBS\PR-447455_BLESSINGTON_GREENWAY\1900_CAD_GIS\910_CAD\20-SHEETS\VALLEYMOUNT\60617025_SHT_BLGWY_140_VALLEYMOUNT_PC_PLAN AND PROFILE.DWG
 Last saved by: MCGOVERNT4
 Project Management Initials: Designer: CL Checked: MC Approved: EOM ISO A1 594mm x 841mm

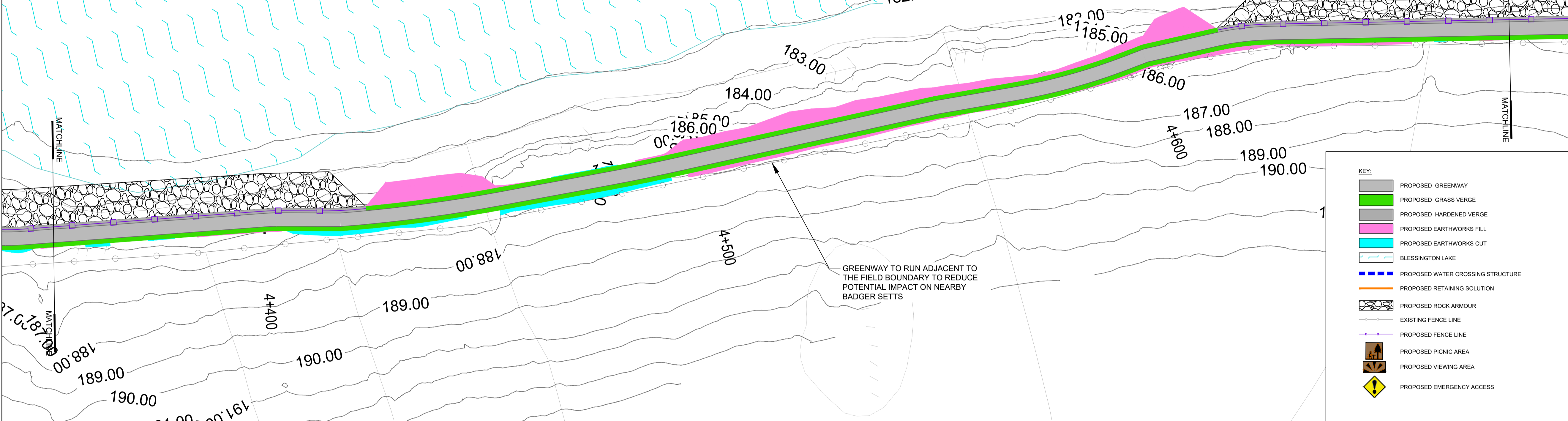

PHASE 1 - CL LONGSECTION
SCALE: H 1:1000, V 1:200

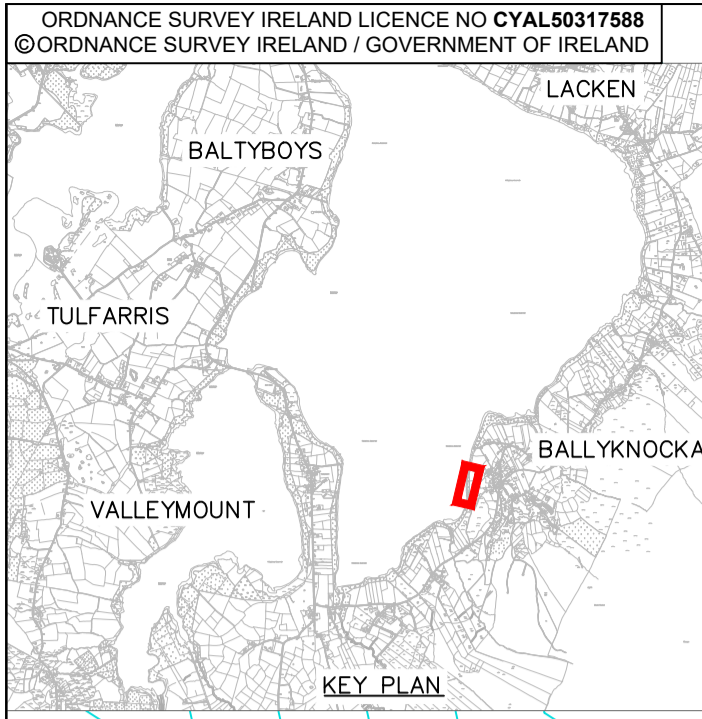
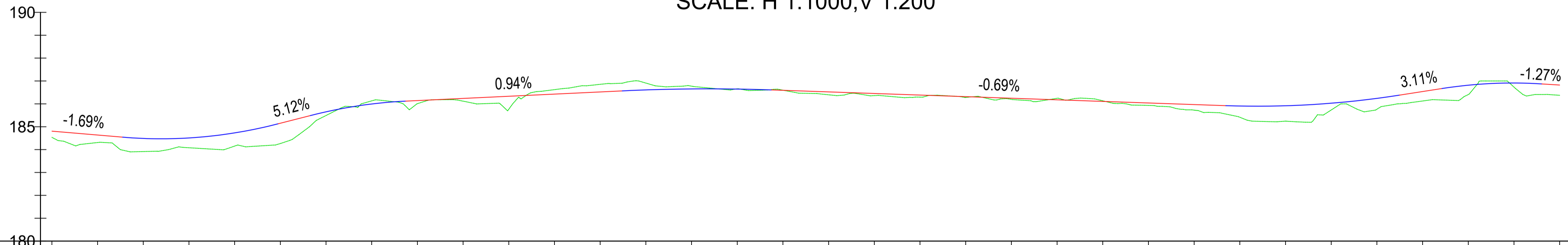

CHAINAGE	4350.000	4400.000	4450.000	4500.000	4550.000	4600.000	4650.000	4680.000	
EXISTING LEVELS	184.536	184.265	185.765	186.656	186.280	185.724	186.125	186.375	
PROPOSED LEVELS	184.805	185.152	186.333	186.646	186.315	185.969	186.538	186.822	
VERTICAL ALIGNMENT	G=-1.69% -1.59.2	L=34.030 K=5.00	G=3.72% 1.79.5	L=20.87 K=5.00	G=0.94% 1.105.9	L=32.70 K=20.00	G=-0.69% -1.144.6	L=37.999 K=10.00	G=3.11% 1.32.2

KEY:

- PROPOSED GREENWAY
- PROPOSED GRASS VERGE
- PROPOSED HARDENED VERGE
- PROPOSED EARTHWORKS FILL
- PROPOSED EARTHWORKS CUT
- BLESSINGTON LAKE
- PROPOSED WATER CROSSING STRUCTURE
- PROPOSED RETAINING SOLUTION
- PROPOSED ROCK ARMOUR
- EXISTING FENCE LINE
- PROPOSED FENCE LINE
- PROPOSED PICNIC AREA
- PROPOSED VIEWING AREA
- PROPOSED EMERGENCY ACCESS

GREENWAY TO RUN ADJACENT TO THE FIELD BOUNDARY TO REDUCE POTENTIAL IMPACT ON NEARBY BADGER SETTS



PROJECT
BLESSINGTON
eGREENWAY



CONSULTANT
AECOM
DOUGLAS BUSINESS CENTRE
CARRIGLINE ROAD
DOUGLAS
CORK
Tel: +353 (0)21 436 5006
www.aecom.com

- NOTES**
1. THIS DRAWING IS TO BE READ IN CONJUNCTION WITH ALL OTHER RELEVANT ENGINEERING DRAWINGS. ANY DISCREPANCIES, ERRORS OR OMISSIONS TO BE BROUGHT TO THE ATTENTION OF THE EMPLOYER.
 2. ALL DIMENSIONS TO BE CHECKED BY THE CONTRACTOR ON SITE PRIOR TO COMMENCEMENT OF WORKS.
 3. EMPLOYER'S REPRESENTATIVE TO BE INFORMED BY THE CONTRACTOR OF ANY DISCREPANCIES PRIOR TO THE COMMENCEMENT OF WORKS ON SITE.
 4. DIMENSIONS OF ALL BOUNDARIES AND ADJOINING ROADS TO BE CHECKED ON SITE PRIOR TO COMMENCEMENT OF WORKS.
 5. DO NOT SCALE. ALL MEASUREMENTS AND COORDINATES TO BE CHECKED ON SITE.
 6. EXISTING FENCE LINES ARE INDICATIVE AND ARE TO BE CONFIRMED ON SITE. EXISTING FENCING IS TO BE REVIEWED ON SITE AND REPLACED WHERE REQUIRED.
 7. EMERGENCY ACCESS POINTS ARE TO BE CLOSED OFF WITH DEMOUNTABLE BOLLARDS. KEYS TO BE HANDED OVER TO THE OVERSEEING ORGANISATION.
 8. EGREENWAY DRAINAGE IS TO BE OVER THE EDGE DRAINAGE
 9. PROPOSED FENCELINE TO BE ERECTED IN ACCORDANCE WITH TII STANDARD DETAIL CC-SCD-00303

ISSUE/REVISION

I/R	DATE	DESCRIPTION
D	DEC 2023	ABP RFI UPDATE
C	MAY 2023	ABP RFI UPDATE
B	MAY 2020	ISSUED FOR INFORMATION
A	APRIL 2020	ISSUED FOR INFORMATION

PROJECT NUMBER
60617025

SHEET TITLE
PLAN AND PROFILE
VALLEYMOUNT
SHEET 14 OF 15

SHEET NUMBER
60617025_SHT_DD_BLGWY_145.14

This drawing has been prepared for the use of AECOM's client. It may not be used, modified, reproduced or relied upon by third parties, except as agreed by AECOM or as required by law. AECOM accepts no responsibility, and denies any liability, whatsoever, to any party that uses or relies on this drawing without AECOM's express written consent. Do not scale this document. All measurements must be obtained from the stated dimensions.